

2627 TIREMAINSVILLE
GREATER TOLEDO
URGENT CARE

RESIDENTIAL

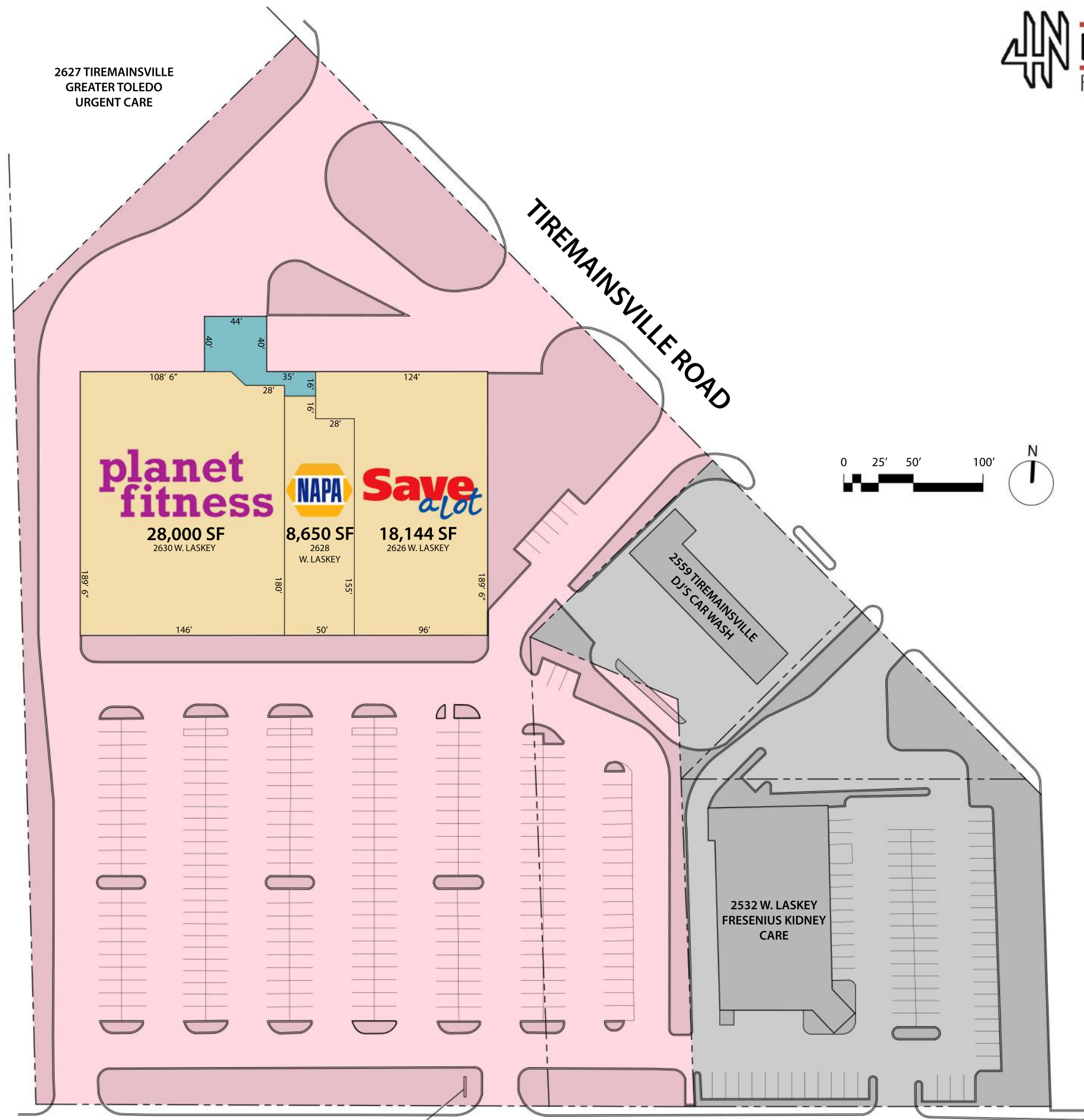

- OWNED BY OTHERS
- SHARED SPACE
- PROPERTY
- AVAILABLE
- LEASED

| DEVELOPMENT DATA | |
|------------------|------------|
| SPACE | AREA |
| PLANET FITNESS | 28,000 SF |
| NAPA AUTO | 8,650 SF |
| SAVE A LOT | 18,144 SF |
| SHARED SPACE | 2,500 SF |
| BUILDING TOTAL | 57,294 SF |
| PARCEL C | 7.63 ACRES |

| PARKING SPACE TABLE | |
|---------------------|----------------|
| TYPE | SPACES |
| REGULAR | 273 |
| HANDICAP | 14 |
| TOTAL | 287 |
| PARKING RATIO | 5.00 / 1,000SF |

DISCLAIMER
THIS DRAWING IS ILLUSTRATIVE AND FOR INFORMATION PURPOSES ONLY AND SHOULD NOT BE CONSIDERED COMPREHENSIVE. DRAWING LAYOUT, SIZES, QUANTITIES, ETC. ARE SUBJECT TO SITE VERIFICATION BY THE USER OF THIS DOCUMENT. THIS LAYOUT MAY NOT BE FINAL, NOR TO SCALE AND IS SUBJECT TO CHANGE WITHOUT NOTICE. PFMG DEVELOPMENT LLC / NUDELL ARCHITECTS IS NOT RESPONSIBLE FOR ERRORS OR OMISSIONS AND NO REPRESENTATION OR WARRANTIES ARE EXPRESSED OR IMPLIED BY THIS DRAWING



SITE LOCATION MAP
NOT TO SCALE

2626-2630 W. LASKEY RD, TOLEDO, OHIO

SCALE: N.T.S.

W. LASKEY ROAD

SITE LEASE PLAN

March 26, 2021
JHN# 2020-017.02